

Domestic & Commercial  
**SCB Range**



Centrifugal **Fans**

# SCB Range – Centrifugal Fans

## Features & Benefits



The SCB Range is a range of centrifugal flow fans which offer excellent pressure development characteristics, designed specifically for use with rigid or flexible ductwork for a wide variety of residential and commercial applications.

- 1 standard size 250mm.
- Suitable for 125mm or 100mm rigid or flexible ducting.
- Air volume flow rates of up to 0.07 m<sup>3</sup>/sec (252m<sup>3</sup>/h).
- Static pressures of up to 230 Pa.
- Greater pressure capability than axial fans.
- IPX4 – Splash proof.
- Shock proof, heat resistant plastic.
- Suitable for operating temperatures up to 40°C.
- Motors are double insulated with built-in thermal overload protection.
- CE Marked and BEAB approved.
- Sealed for life ball bearings to operate at any angle.
- Timer models adjustable from 3-15 minutes.
- Anti –vibration gasket between fan casing and wall for quiet operation.
- Supplied with back draught shutter and inlet cone for improved performance.

### Features & Benefits

**Motor Protection** – Each SCB motor is double insulated so no earth is required with integral thermal overload protection which prevents the motor from overheating.

**Range** - One standard size, 250mm.

**Options** - The SCB range, dependant on model, incorporate a run on timer adjustable between 3 and 15 minutes; a dynamic type humidistat with anti – hunting feature; and can be operated via a pull cord.

**Safety** – SCB fans are IPX4 Splash proof, protected against water splashing from all directions which means they can be safely installed in Zones I and II in accordance with IEE Wiring Regulations.

**Ease of installation** – Designed and supplied with all the necessary fixings.

**Material Strength** - Units are manufactured from shock proof, heat resistant white plastic, which is durable and non corrosive.

**Mounting** – Each unit is suitable for wall, panel or ceiling mounting installations.

**Full Ancillary range** – Wall kits, locking rings.

**Reliability**– Motors have sealed for life bearings.

**Warranty** – Each SCB has a 2 year warranty.

### Applications

Shower rooms, bathrooms, kitchens, utility rooms, residential and commercial facilities.

## Accessories



Flexible Wall Sleeve



External Wall Grille



Fan Locking Ring



Shutter



Telescopic Wall Sleeve

# SCB Range - Centrifugal Fans

## Product Information



Product Code	Description
SCB250	Basic unit, fan only
SCB250T	Run-on timer unit
SCB250H	Humidistat, pull cord, run on timer and neon. The neon light is activated by the pull cord. This cord can be removed and the unit wired to activate via a light switch

Product Code	Voltage	Maximum Volume		Mounting Arrangement			Operation						
		l/sec	m <sup>3</sup> /hr	Ceiling	Wall	Ducting	Fan Only	Pull Cord	Run on Timer	Electric Shutter	Humidistat	PIR	
SCB250	230	70	252	√	√	√	√						
SCB250T	230	70	252	√	√	√	√			√			
SCB250H	230	70	252	√	√	√	√	√	√	√		√	

Note: The SCE Range is not suitable for Window or Roof mounting.

t: 01384 275800

f: 01384 275810

visit: [eltafans.com](http://eltafans.com)



# SCB Range - Centrifugal Fans

## Dimensional Data

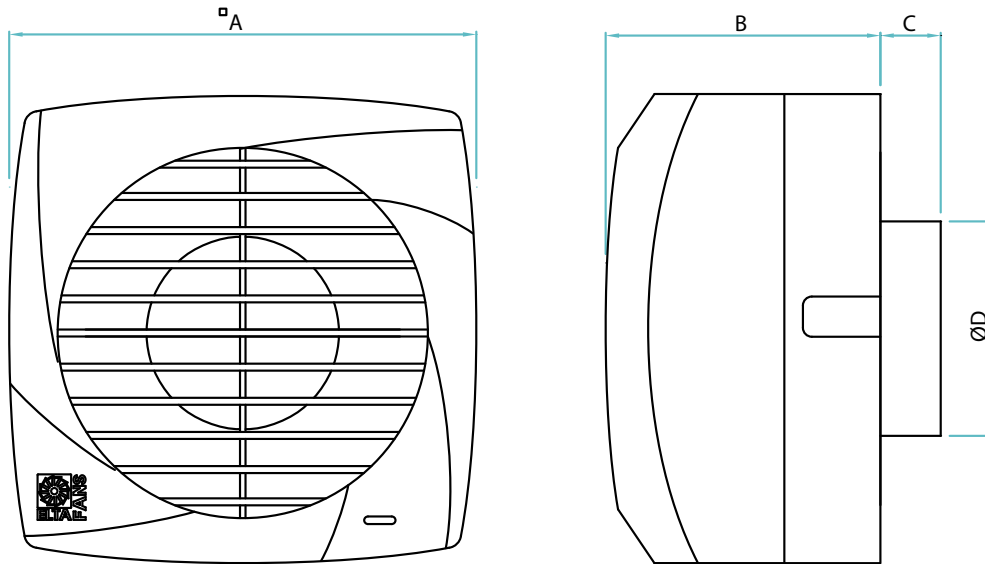

CENTRIFUGAL

Product Code	A	B	C	D	Weight kg
SCB250	210	122	28	97 / 119	2.0

## Accessories



Flexible Wall Sleeve



External Wall Grille



Fan Locking Ring



Shutter



Telescopic Wall Sleeve

# SCB Range - Centrifugal Fans

## Performance & Electrical Data

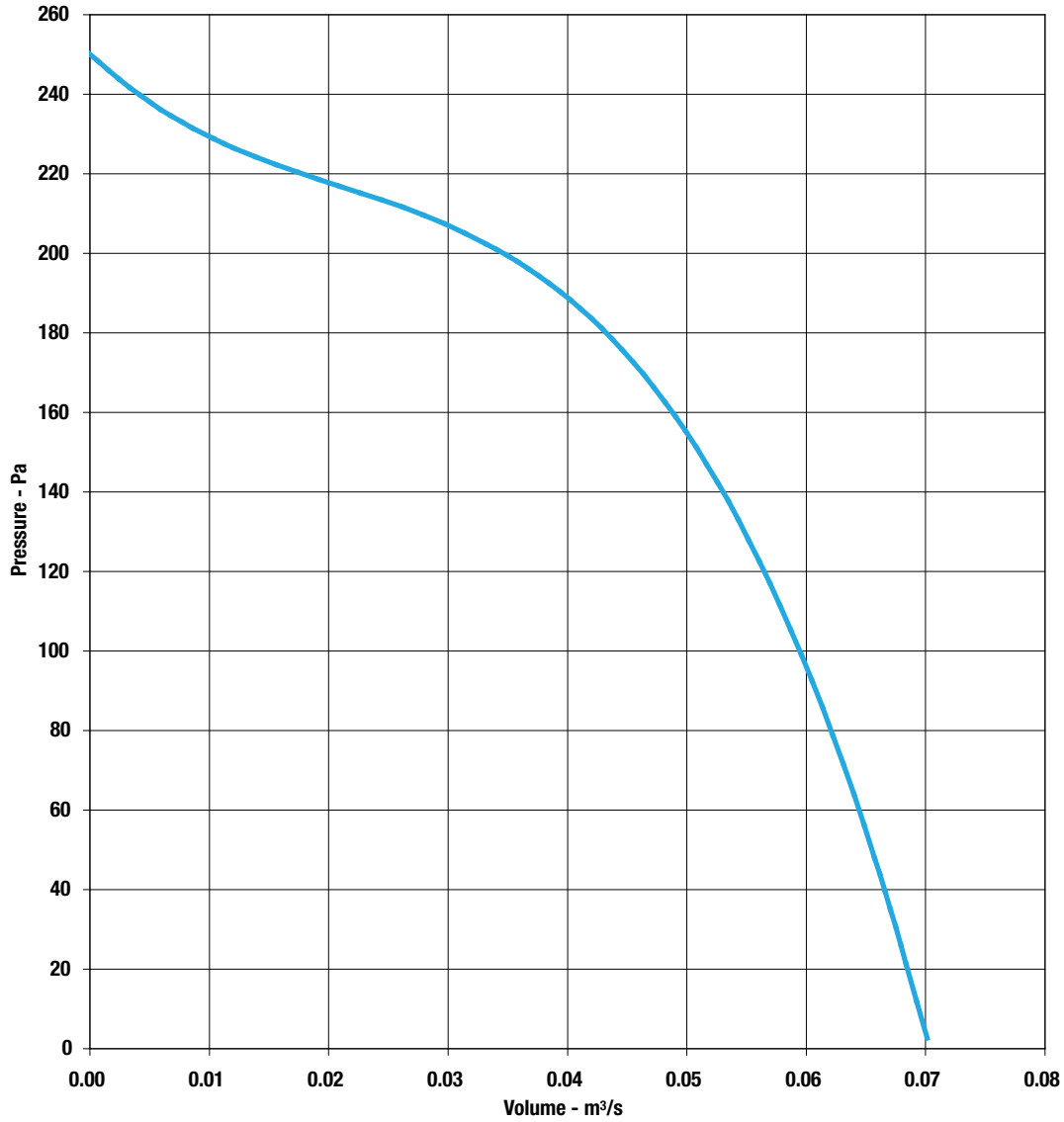

CENTRIFUGAL

	SCB250
Diameter.	100/120mm
Volts.	230
Watts.	45
R.P.M.	2500
l/sec.	70
Max Pa.	250
dBA @ 3m	52

### Accessories



Flexible Wall Sleeve



External Wall Grille



Fan Locking Ring



Shutter



Telescopic Wall Sleeve

# SCB Range - Centrifugal Fans Accessories



## Flexible Wall Sleeve

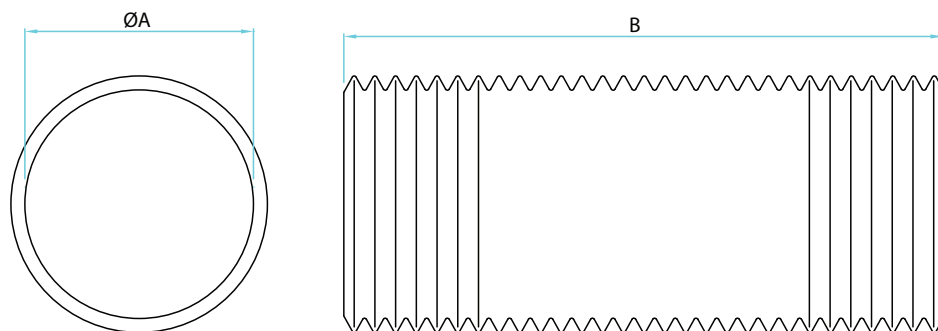

- Comprises durable white plastic grille for external mounting
- 3 metres of pvc flexible duct

Product Code	A	B	Weight kg
SK100SAWKflex	100	356	0.20
SK125SAWKflex	125	356	0.23
SK150SAWKflex	150	356	0.26

## External Wall Grille

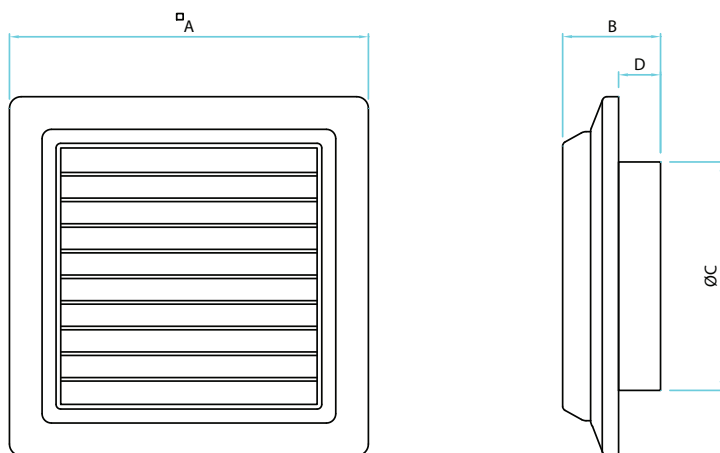

- Durable white plastic
- Mounted independently of fan

Product Code	A	B	C	D	Weight kg
SKGW-100D	154	42	98	18	0.114
SKGW-125D	200	58	123	28	0.210
SKGW-150D	200	58	148	28	0.210

## Fan Locking Ring

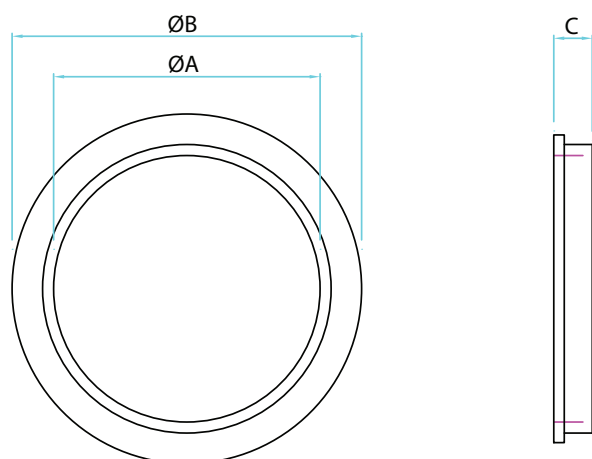

- Durable white plastic
- Fits directly to fan allowing easy installation without fixing screws

Product Code	A	B	C	Weight kg
SK100SACR	100	132	15	0.048
SK125SACR	125	155	26	0.075
SK150SACR	150	187	26	0.100

# SCB Range - Centrifugal Fans Accessories



## Shutter

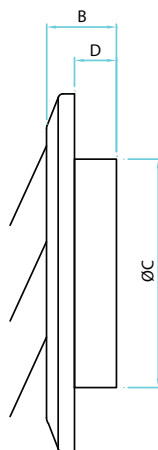
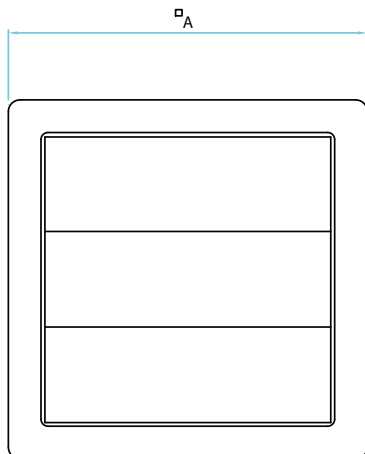

- Durable white plastic
- Opens automatically with airflow
- Mounted independently of fan

Product Code	A	B	C	D	Weight kg
SKFLW-100D	154	42	98	18	0.078
SKFLW-125D	200	58	123	28	0.178
SKFLW-150D	200	58	148	28	0.182

## Telescopic Wall Sleeve

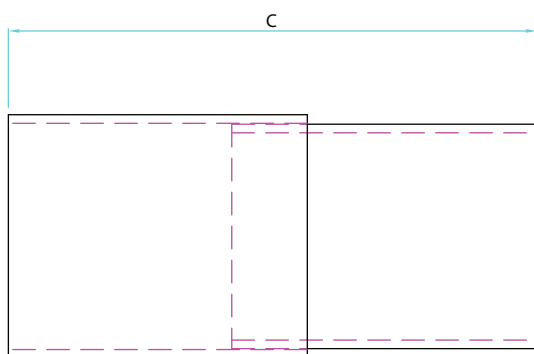
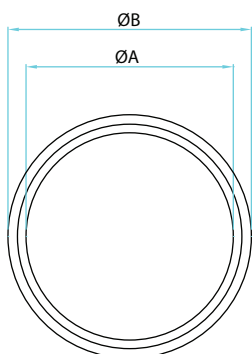

- Galvanised steel telescopic sleeve
- Minimum length of 160mm and maximum length of 300mm

Product Code	A	B	C	Weight kg
SK100SAWKTLSCOP	100	105	203/355	0.305
SK125SAWKTLSCOP	125	130	203/355	0.385
SK150SAWKTLSCOP	150	155	203/355	0.474



**Elta Fans Ltd - Applied Technology**

17 Barnes Wallis Road,  
Segensworth East Industrial Estate,  
Fareham, Hampshire, P015 5ST, United Kingdom.

**Visit:** [eltafans.com](http://eltafans.com)

**e-mail:** [mailbox@eltafans.co.uk](mailto:mailbox@eltafans.co.uk)

**Applied Technology:**

**Tel:** +44 (0) 1489 566500

**Fax:** +44 (0) 1489 566555

**Building Services:**

**Tel:** +44 (0) 1384 275800

**Fax:** +44 (0) 1384 275810

**Export:**

**Tel:** +44 (0) 1489 566523

**Fax:** +44 (0) 1489 566543