

HERITAGE

FCHE/FCHD



Roof Mounted
Centrifugal Fans

features & benefits



Heritage FCHE/FCHD

The Heritage FCHE/FCHD is a range of roof mounted centrifugal fans which is designed to handle clean, grease laden or contaminated air, whilst providing easy access for cleaning.

- Air volume flow rates of up to 4.1 m³/sec.
- Static pressures of up to 600 Pa.
- Motors standard squirrel cage induction, mounted out of the air stream.
- Motors IP54 protection and Class F insulation.
- Suitable for operating temperatures up to 50° C.
- Cowls are of galvanised steel construction.
- Backward curved centrifugal impellers.
- Motor and impeller balanced to quality class G6.3.
- Can be mounted at angles of up to 15°.

Features & Benefits

Material strength – The all metal cowls have a robust, long lasting construction, manufactured from galvanised steel and powder coated after forming.

High temperature - With motors out of the air stream, the FCHE/FCHD is suitable for a wide range of applications from contaminated air to elevated temperatures.

Impeller design – Aerodynamically designed backward curved centrifugal impellers in either sheet steel or aluminium dependant upon impeller selection.

Reliability – Motors have sealed for life bearings.

Easy cleaning - The wind band is held in place with toggle clamps to permit easy access for cleaning and maintenance when the units are installed in atmospheres that are dirt laden.

Mounting - Can be mounted at angles of up to 15° which means the fans can be fitted directly to pitched roofs.

Accessories – Inverters

Tested to the very latest standards – FCHE/FCHD units are tested to ISO 5801:1997 (airside performance) and to BS 848 Pt 2:1985 (sound performance) meaning accurate, up to date information on performance and noise data that can be relied upon.

Quality assurance – All units are designed and manufactured with procedures as defined in BS EN ISO 9001: 2000.

Warranty – Each FCHE/FCHD has a one year warranty.

Typical Applications

Industrial, commercial kitchens and catering, hospitals, bakeries, forges and foundries.

dimensional data

Heritage FCHE/FCHD

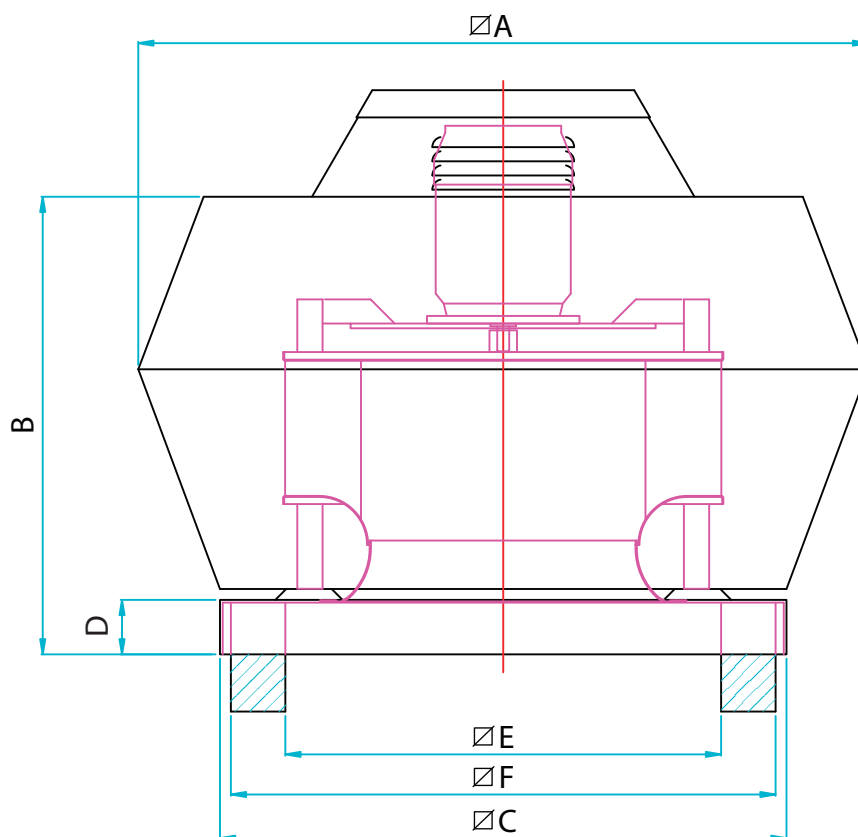

Product Code	A	B	C	D	E	F	Weight kg		
							4-Pole	6-Pole	8-Pole
FCHE/D315	520	310	430	50	310	410	16	16	-
FCHE/D350	665	420	520	50	400	500	26	26	-
FCHE/D400	665	420	520	50	400	500	26	26	-
FCHE/D450	900	540	740	60	620	720	49	49	-
FCHE/D500	900	540	740	60	620	720	57	51	-
FCHE/D560	900	540	740	60	620	720	65	56	55
FCHE/D630	1160	665	830	60	710	810	97	78	74
FCHE/D710	1160	665	830	60	710	810	-	95	83

performance & electrical data

Heritage FCHE/FCHD

Single Phase - 220V-240V / 50Hz

Product Code	Speed r/min	Airflow m ³ /s @ Static Pressure Pa										Motor Electrical Data		Output kW	dBA @ 3m
		0	50	100	150	200	250	300	400	500	600	FLC Amps	SC Amps		
		FCHE314	1440		0.50	0.45	0.41	0.35	0.28						
FCHE354	1440		0.78	0.73	0.68	0.62	0.55	0.45				3.86	23.2	0.55	51
FCHE404	1440		1.08	1.03	0.97	0.91	0.84	0.76	0.52			3.86	23.2	0.55	54
FCHE454	1440		1.54	1.48	1.41	1.35	1.28	1.22	1.06	0.83		5.33	32.0	0.75	56
FCHE504	1440		2.18	2.11	2.04	1.97	1.89	1.81	1.63	1.42	1.14	9.40	56.4	1.50	60

Sound levels are average spherical free field values at 50% peak pressure for comparative purposes only.

Three Phase - 380V-415V / 50Hz

Product Code	Speed r/min	Airflow m ³ /s @ Static Pressure Pa									Motor Electrical Data		Output kW	dBA @ 3m	
		0	50	100	150	200	250	300	400	500	FLC Amps	SC Amps			
FCHE568	720		1.38	1.25	1.08	0.79						1.38	8.3	0.37	47
FCHE638	720		2.04	1.88	1.69	1.43	1.00					1.51	9.1	0.55	49
FCHE716	860		4.08	3.95	3.80	3.65	3.50	3.33	2.93	2.37		5.00	30.0	2.20	60
FCHE718	720		2.90	2.74	2.56	2.32	2.01	1.55				3.02	18.1	1.10	52

sound data

Heritage FCHE/FCHD

Single Phase

Product Code	Octave Band								dBA @ 3m
	63 Hz	125 Hz	250 Hz	500 Hz	1 kHz	2 kHz	4 kHz	8 kHz	
FCHE314	81	77	69	66	58	58	56	50	47
FCHE354	79	77	73	70	61	63	62	52	51
FCHE404	82	80	75	72	65	66	66	59	54
FCHE454	84	82	77	74	68	69	69	65	56
FCHE504	87	87	82	76	73	73	73	70	60

Three Phase

Product Code	Octave Band								dBA @ 3m
	63 Hz	125 Hz	250 Hz	500 Hz	1 kHz	2 kHz	4 kHz	8 kHz	
FCHD568	77	74	69	62	62	58	58	53	47
FCHD638	78	77	73	64	64	59	60	56	49
FCHD716	89	90	85	75	73	71	69	69	60
FCHD718	81	80	76	67	67	62	63	59	52

performance curves

Heritage FCHE 4 pole range

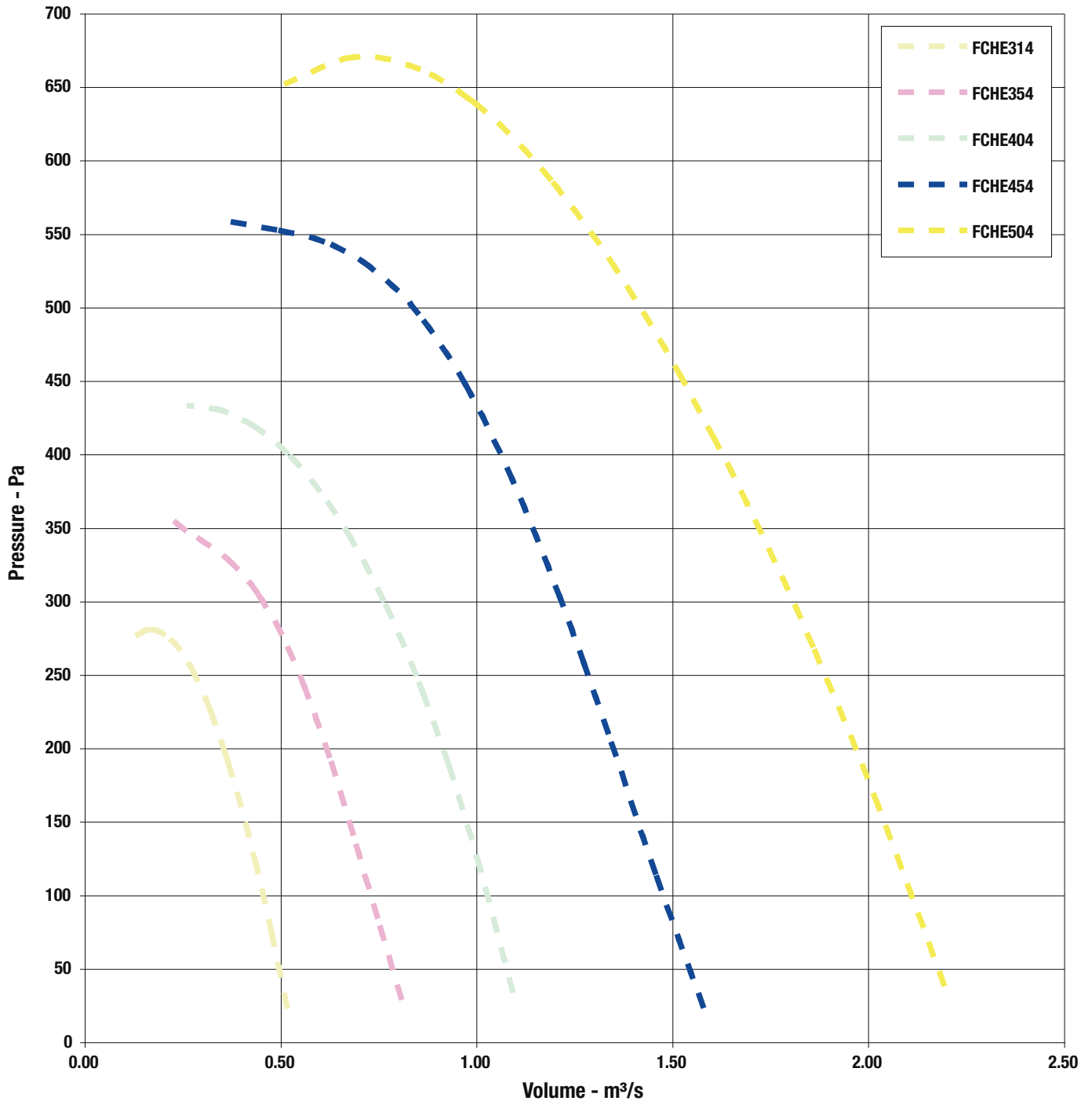

performance curves

Heritage FCHD 6 & 8 pole range

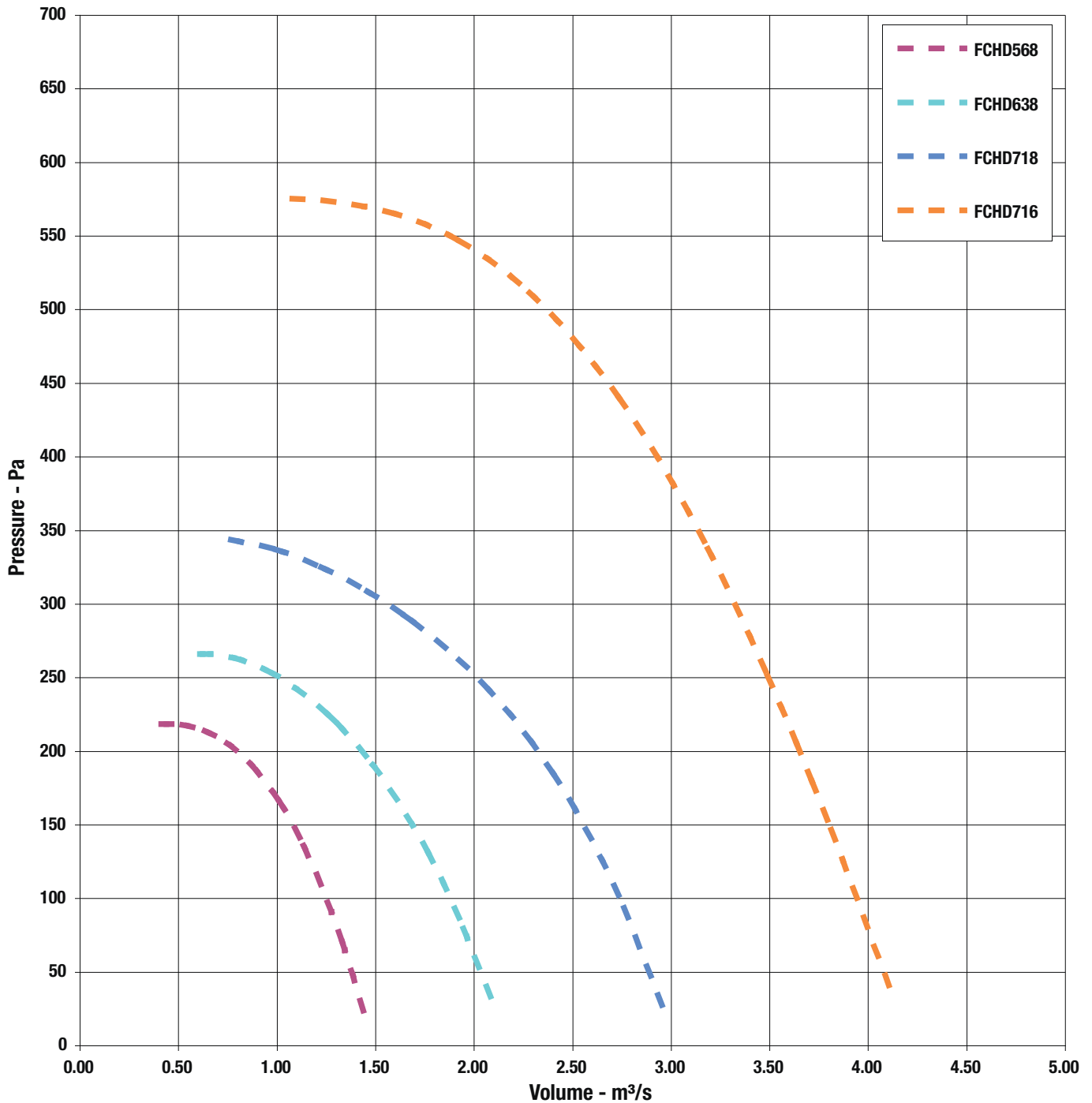

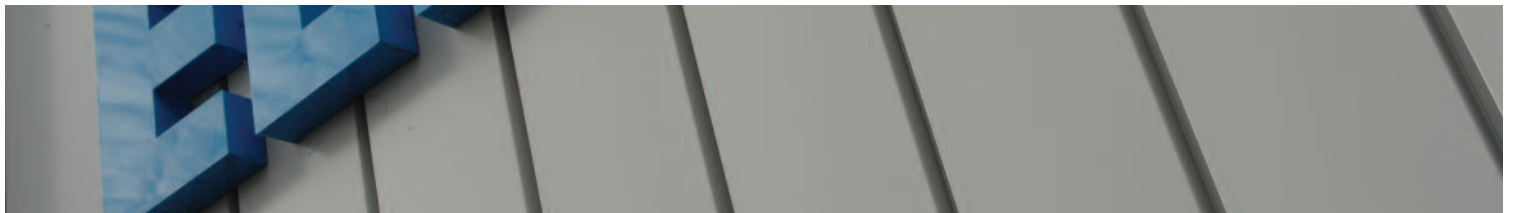

Elta Fans Ltd - Applied Technology

17 Barnes Wallis Road,
Segensworth East Industrial Estate,
Fareham, Hampshire, P015 5ST, United Kingdom.

Visit: eltafans.com

e-mail: mailbox@eltafans.co.uk

Applied Technology:

Tel: +44 (0) 1489 566500

Fax: +44 (0) 1489 566555

Building Services:

Tel: +44 (0) 1384 275800

Fax: +44 (0) 1384 275810

Export:

Tel: +44 (0) 1489 566500

Fax: +44 (0) 1489 566555